

MAGANJO ROAD

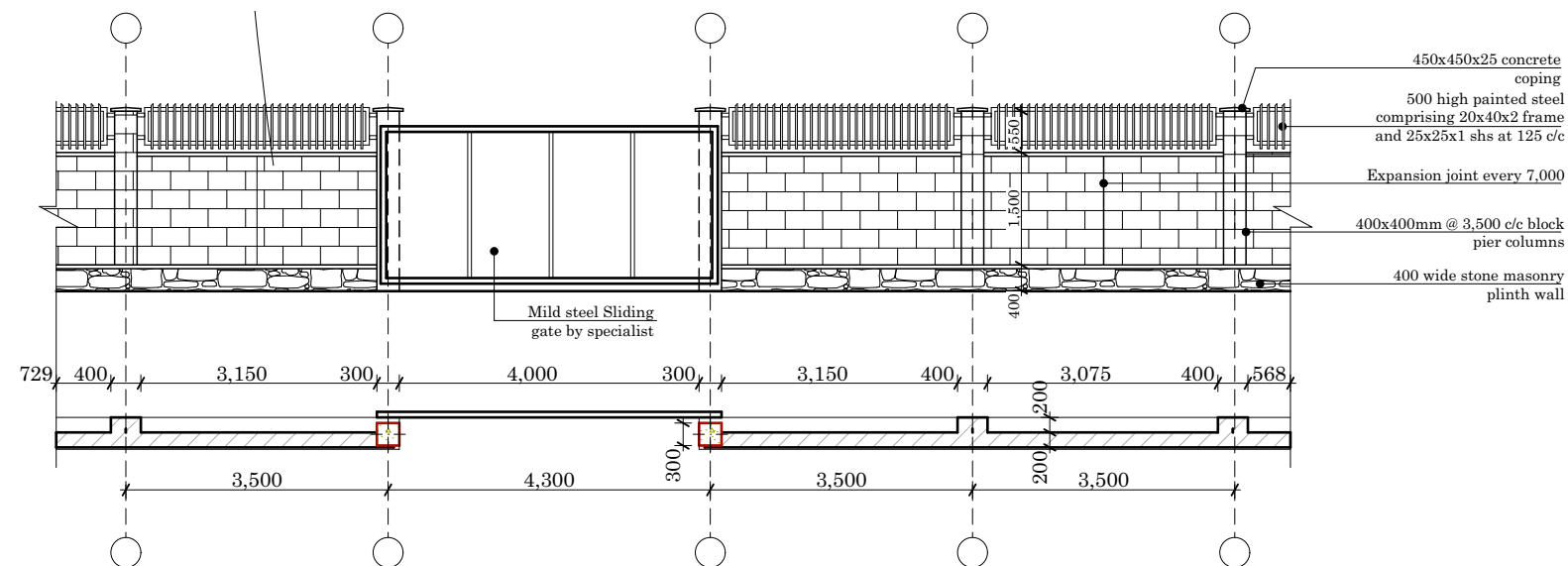

BOUNDARY WALL
1:100

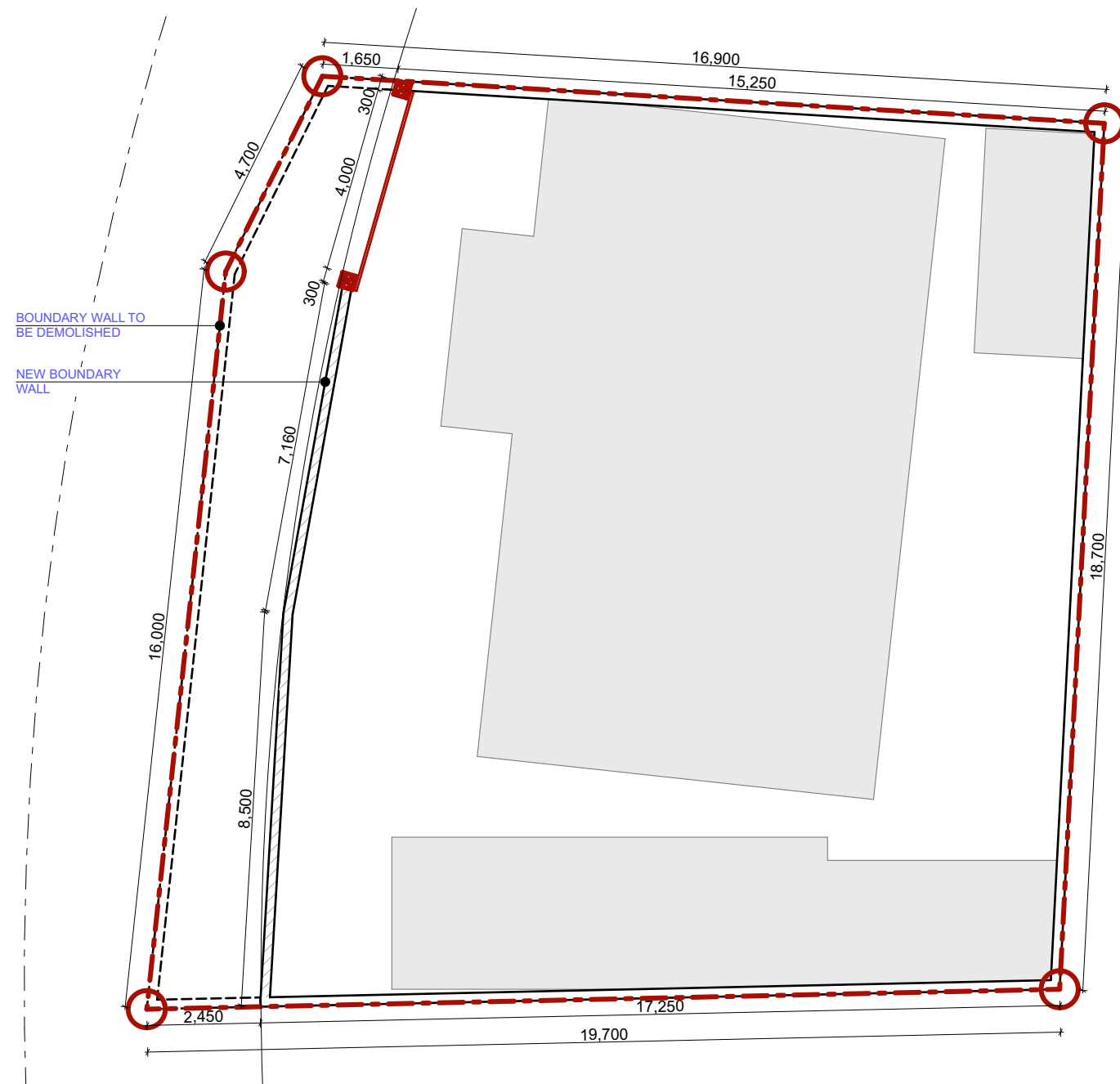

PROJECT AFFECTED PERSON		
LUKWAGO STEVE SSALI		
REFERENCE NUMBER		
JK-RHS-003		
	MATTERS ARISING	REMEDY
	BOUNDARY WALL & GATE AFFECTED	DEMOLISH EXISTING, CONSTRUCT NEW BOUNDARY WALL

DESIGN OF FACILITIES FOR 14 NO. PAPS
FOR SELECTED ROADS IN NANSANA
MUNICIPALITY

NANSANA MUNICIPAL COUNCIL
P. O BOX 7218 KAMPALA
TEL: 0782 408 022

CONSULTANT	PROJECT NO.
	SHEET NO. 01
	DATE.
	PAPER SIZE.



CONSULTANT	PROJECT NO.
	SHEET NO. 02
	DATE.
	PAPER SIZE.

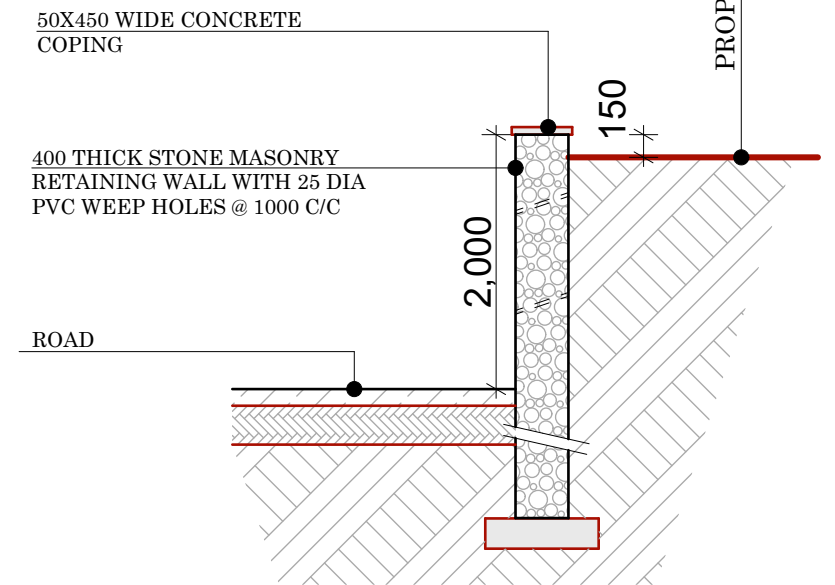
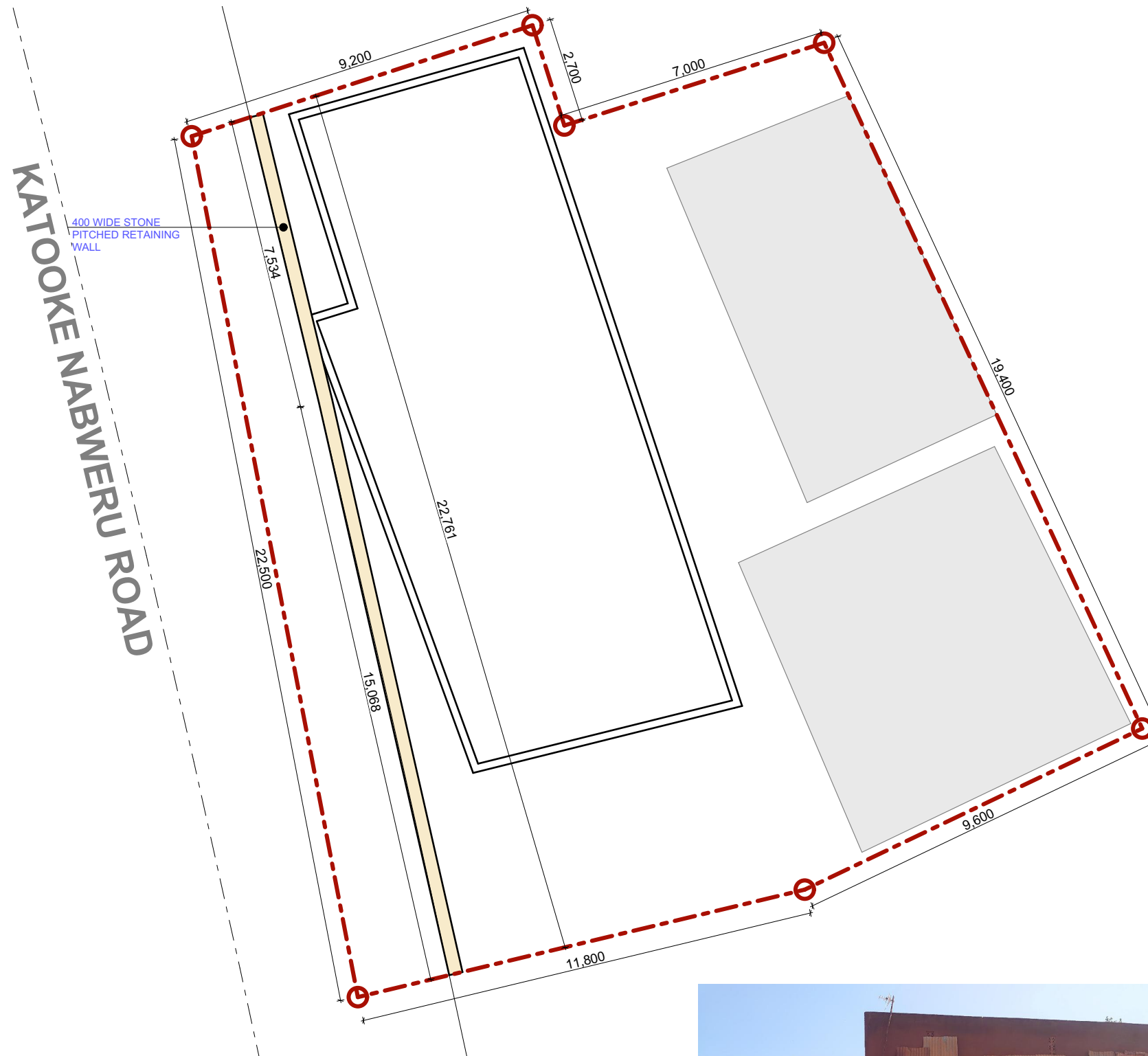

SECTION THRU' RETAINING WALL

PROJECT AFFECTED PERSON		
NAKITYO MARGARETE		
REFERENCE NUMBER		
KN-RHS-041		
	MATTERS ARISING	REMEDY
1	BOUNDARY WALL AFFECTED BY R.O.W.	CONSTRUCT STONE PITCHED RETAINING WALL TO PROTECT BUILDING FOUNDATIONS
2	DEEP EXCAVATION LIKELY TO AFFECT FOUNDATION OF STRUCTURE	

DESIGN OF FACILITIES FOR 14 NO. PAPS
FOR SELECTED ROADS IN NANSANA
MUNICIPALITY

NANSANA MUNICIPAL COUNCIL
P. O BOX 7218 KAMPALA
TEL: 0782 408 022

CONSULTANT	PROJECT NO.
	SHEET NO. 03-A
	DATE.
	PAPER SIZE.



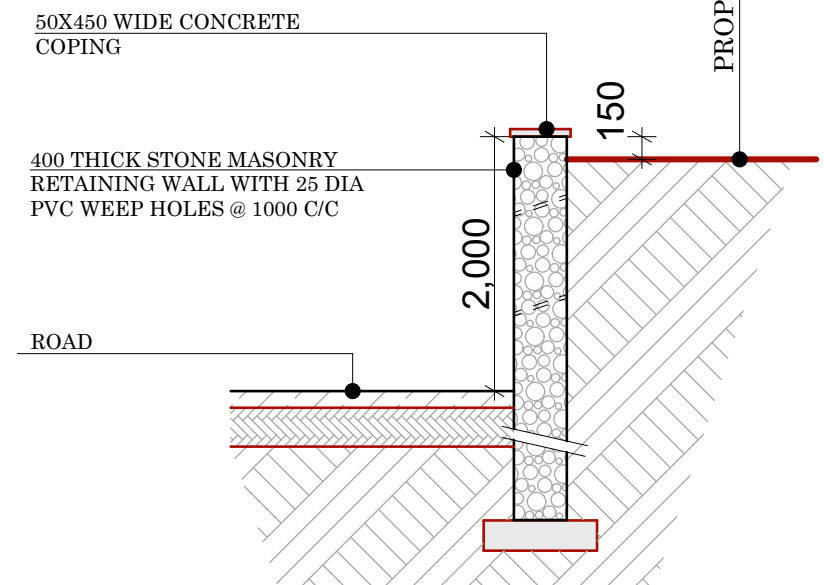

A photograph of a large, single-story building with a rusted corrugated metal roof and walls. The building is situated behind a low, rough stone wall. A dirt road is in the foreground, and a utility pole is visible to the right.

PROJECT AFFECTED PERSON

NAKITYO MARGARETE

REFERENCE NUMBER

KN-RHS-041

	MATTERS ARISING	REMEDY
1	BOUNDARY WALL AFFECTED BY R.O.W.	-CONSTRUCT STONE PITCHED RETAINING WALL TO PROTECT
2	DEEP EXCAVATION LIKELY TO AFFECT FOUNDATION OF STRUCTURE	BUILDING FOUNDATIONS -DEMOLISH AFFECTED STRUCTURE AND CONSTRUCT NEW BLOCK OF SHOPS 1.5M AWAY FROM R.O.W

DESIGN OF FACILITIES FOR 14 NO. PAPS FOR SELECTED ROADS IN NANSANA MUNICIPALITY

NANSANA MUNICIPAL COUNCIL
P. O BOX 7218 KAMPALA
TEL: 0782 408 022

CONSULTANT	PROJECT NO.
	SHEET NO. 03-B
	DATE.
	PAPER SIZE.

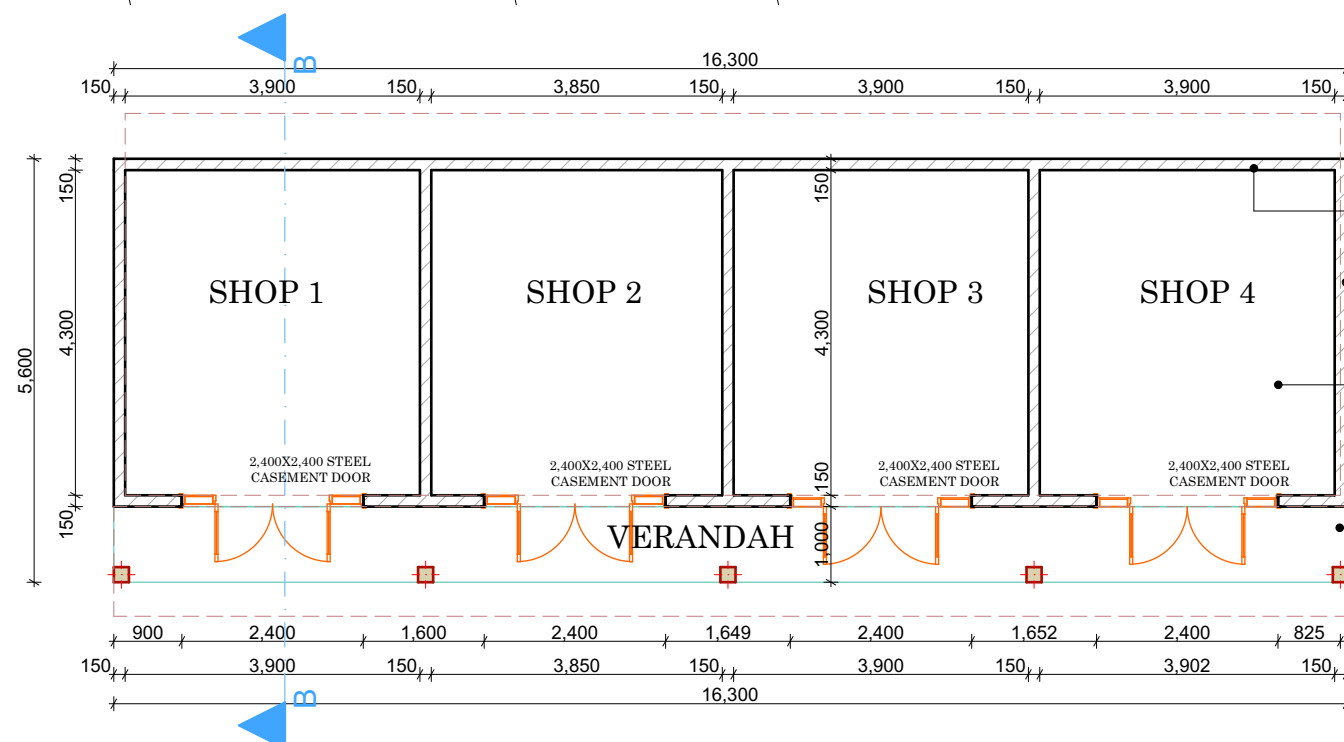

INTERNAL WALL FINISH
TWO COATS OF SILK VINYL
PAINT TO 15 THICK
PLASTER TO BURNT CLAY
BRICK WALL

EXTERNAL WALL FINISH
TWO COATS OF
WEATHERGAURD PAINT
TO 15 THICK PLASTER TO
BURNT CLAY BRICK WALL

FLOOR FINISH
50 THICK CEMENT
SCREED ON 100 THICK
CONCRETE SLAB

FLOOR FINISH
50 THICK CEMENT
SCREED ON 100 THICK
CONCRETE SLAB

ROOF NOTES
28 GAUGE CGI SHEETS ON
50X75 PURLINS ON
100X50 RAFTERS ON
50X100 STRUTS & TIES ON
150X75 TIE BEAM ON
50X75 WALL PLATE ON
25X225 FASCIA BOARD

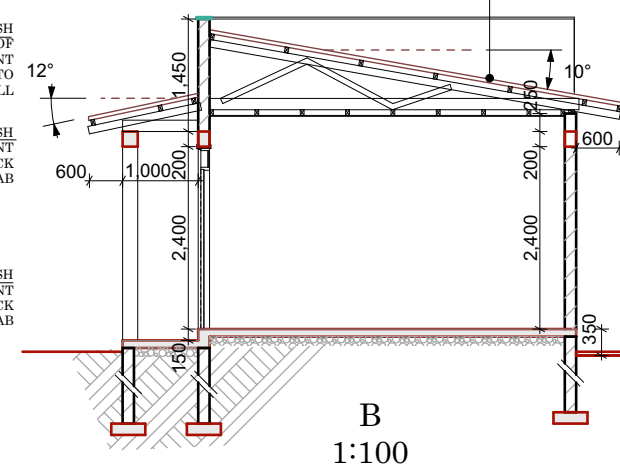

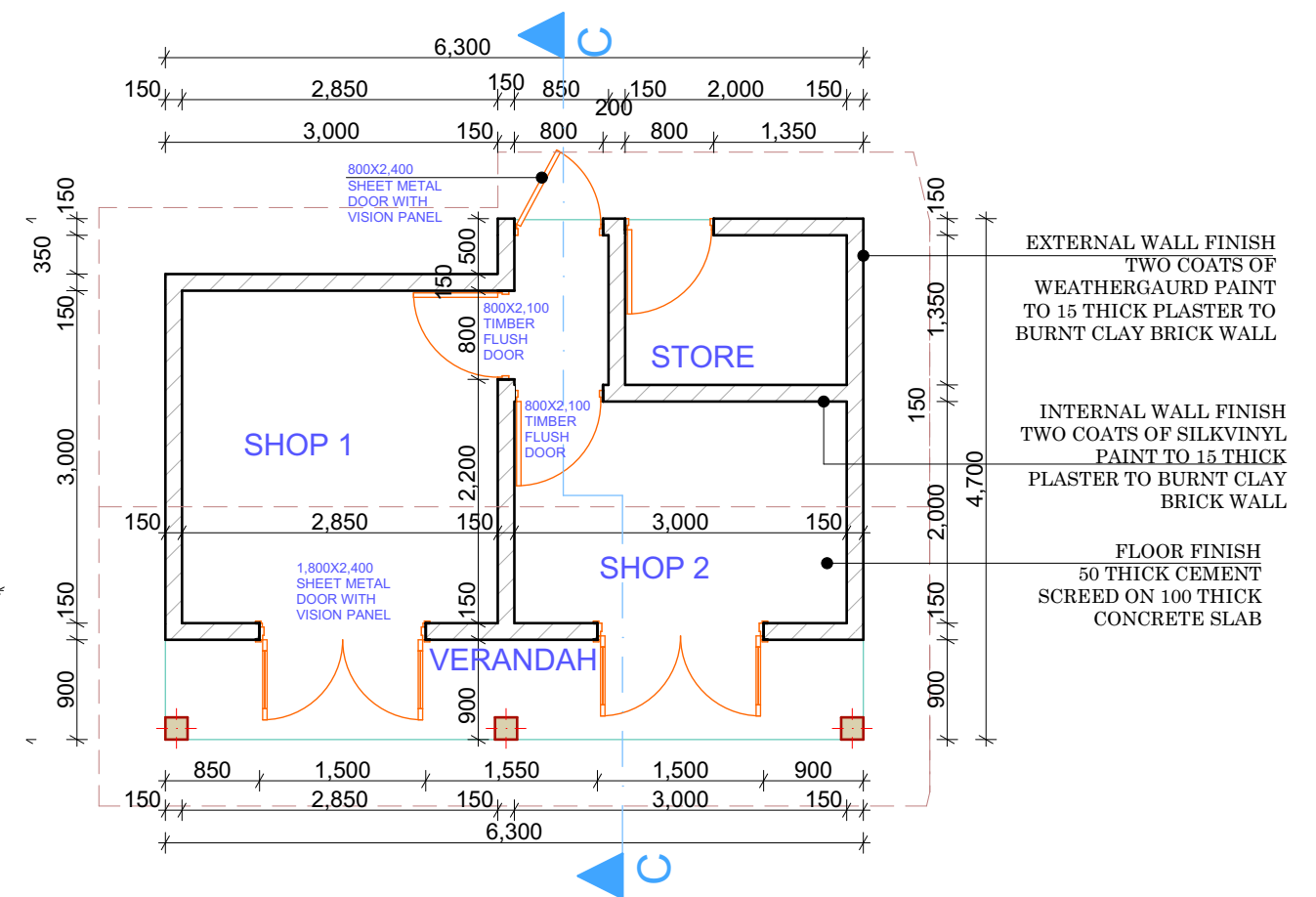

PROJECT AFFECTED PERSON		
NASSALI REBECCA		
REFERENCE NUMBER		
KN-RHS-043		
	MATTERS ARISING	REMEDY
1	BLOCK OF SHOPS (2NO.) AFFECTED BY R.O.W	-DEMOLISH AND CONSTRUCT NEW BLOCK 1.5M AWAY FROM R.O.W

DESIGN OF FACILITIES FOR 14 NO. PAPS FOR SELECTED ROADS IN NANSANA MUNICIPALITY

NANSANA MUNICIPAL COUNCIL
P. O BOX 7218 KAMPALA
TEL: 0782 408 022

CONSULTANT	PROJECT NO.
	SHEET NO. 05
	DATE.
	PAPER SIZE.

KATOKE NABWERU ROAD

ONE ROOM ON THE
STRUCTURE TO BE
DEMOLISHED

NEW BOUNDARY
WALL

1.800X2,100 SHEET
METAL GATE

NEW 4M HIGH
EDGE WALL

BOUNDARY WALL
1:100

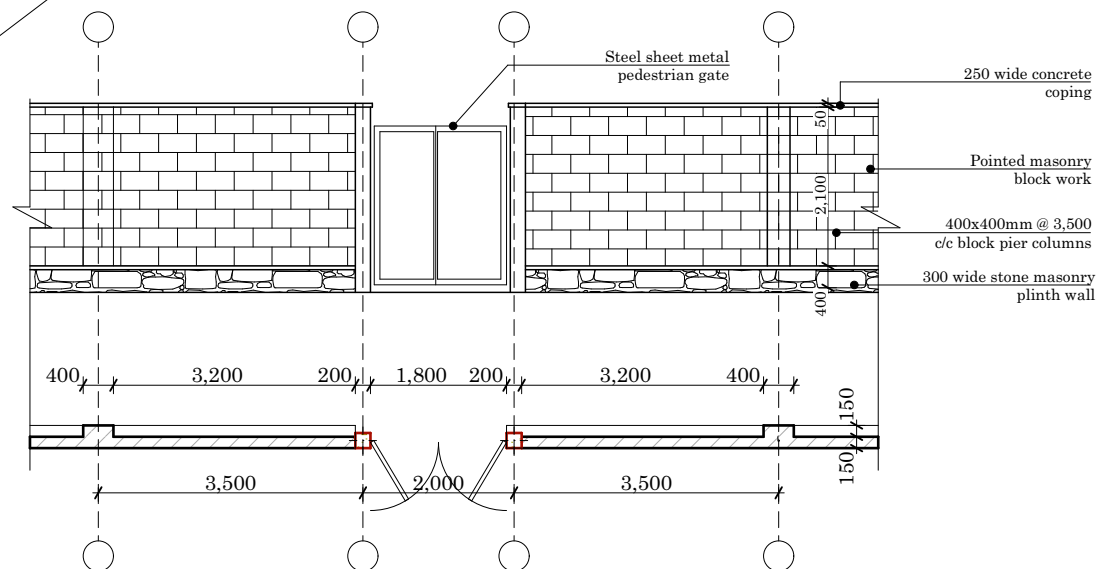

PROJECT AFFECTED PERSON		
NANKYA EVA		
REFERENCE NUMBER		
KN-RHS-042		
	MATTERS ARISING	REMEDY
1	RESIDENTIAL ROOMS AND BOUNDARY WALL AFFECTED BY R.O.W	-DEMOLISH AFFECTED ROOM UPTO 3M FROM R.O.W. - CONSTRUCT BOUNDARY WALL AT 1.5 FROM HOUSE

DESIGN OF FACILITIES FOR 14 NO. PAPS
FOR SELECTED ROADS IN NANSANA
MUNICIPALITY

NANSANA MUNICIPAL COUNCIL
P. O BOX 7218 KAMPALA
TEL: 0782 408 022

CONSULTANT	PROJECT NO.
	SHEET NO. 06
	DATE.
	PAPER SIZE.

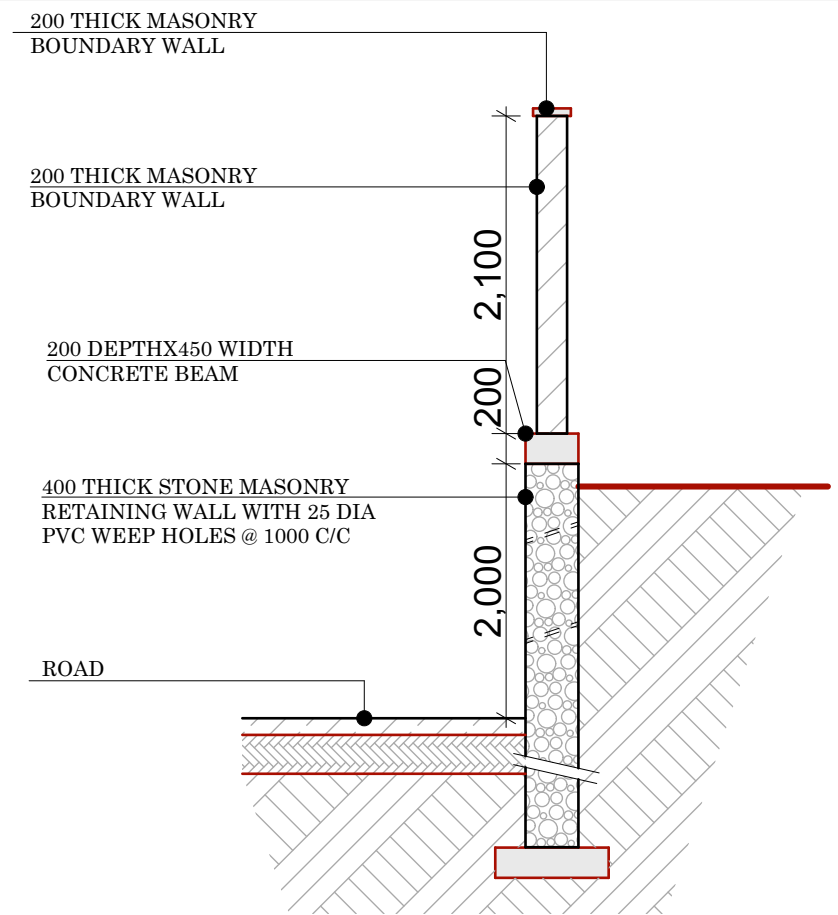

SECTION THRU' RETAINING WALL

PROJECT AFFECTED PERSON		
TUGUME MARGARETE		
REFERENCE NUMBER		
KN-RHS-038		
	MATTERS ARISING	REMEDY
1	EXISTING STONE PITCHED RETAINING WALL TO BE AFFECTED BY R.O.W	-DEMOLISH EXISTING AND REPLACE AT EXTENT OF R.O.W

DESIGN OF FACILITIES FOR 14 NO. PAPS
FOR SELECTED ROADS IN NANSANA
MUNICIPALITY

NANSANA MUNICIPAL COUNCIL
P. O BOX 7218 KAMPALA
TEL: 0782 408 022

CONSULTANT	PROJECT NO.
	SHEET NO. 08
	DATE.
	PAPER SIZE.



KATOKE NABWERU ROAD

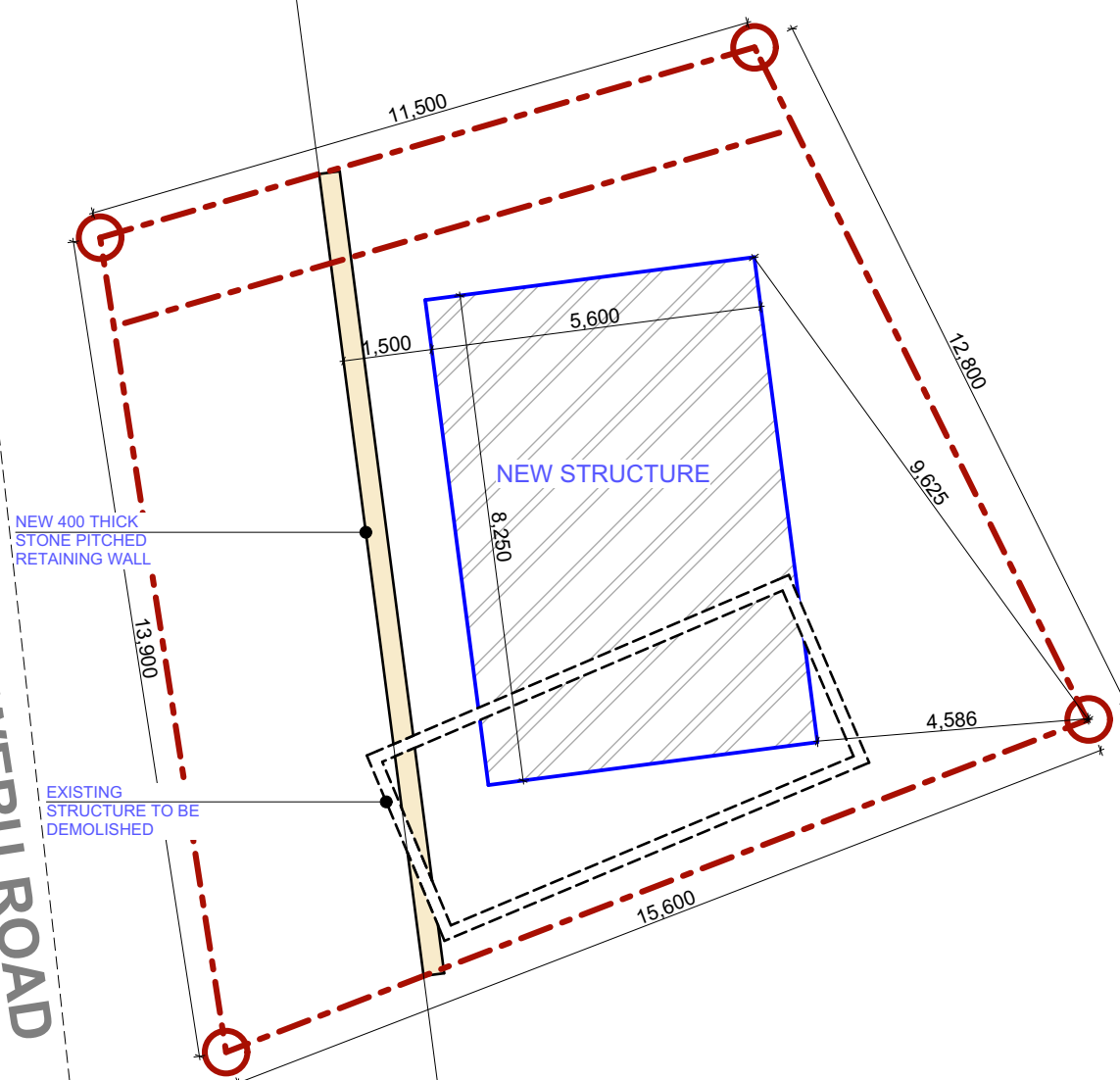

50X450 WIDE CONCRETE COPING

400 THICK STONE MASONRY RETAINING WALL WITH 25 DIA PVC WEEP HOLES @ 1000 C/C

ROAD

PROPERTY SIDE

SECTION THRU' RETAINING WALL

PROJECT AFFECTED PERSON		
DAVID		
REFERENCE NUMBER		
KN-RHS-037		
	MATTERS ARISING	REMEDY
1	BLOCK OF SHOPS AFFECTED BY EXTENT OF NEW ROAD	-DEMOLISH AND CONSTRUCT NEW BLOCK 1.5M AWAY FROM R.O.W -CONSTRUCT NEW RETAINING WALL

DESIGN OF FACILITIES FOR 14 NO. PAPS FOR SELECTED ROADS IN NANSANA MUNICIPALITY

NANSANA MUNICIPAL COUNCIL
P. O BOX 7218 KAMPALA
TEL: 0782 408 022

CONSULTANT	PROJECT NO.
	SHEET NO. 09
	DATE.
	PAPER SIZE.

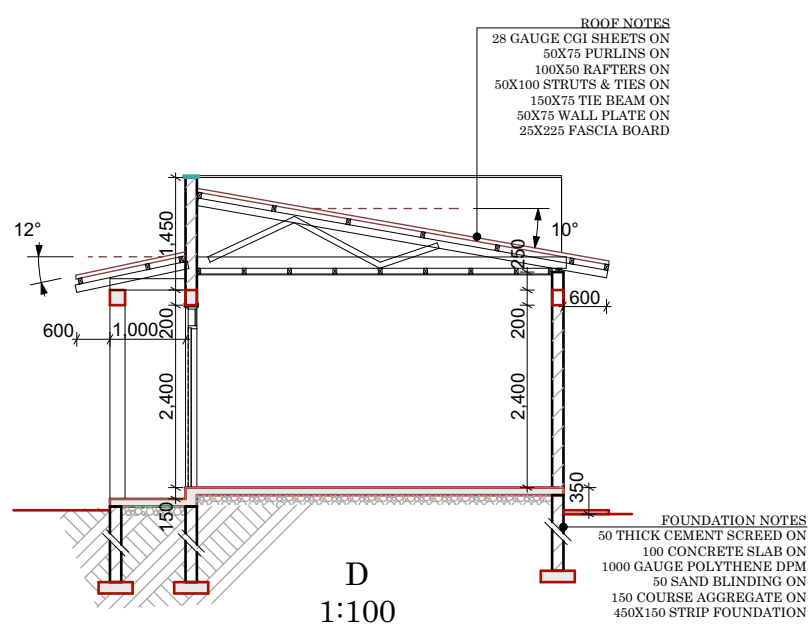
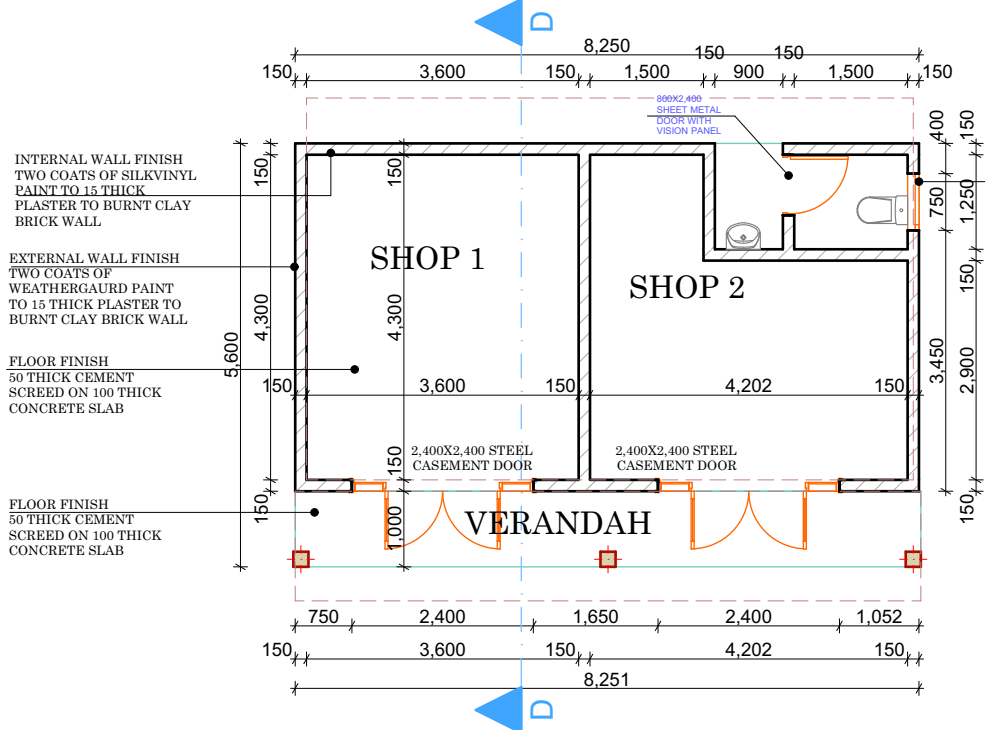

KATOOKE NABWERU ROAD

EXISTING
STRUCTURE TO BE
DEMOLISHED

NEW 400 THICK
STONE PITCHED
RETAINING WALL

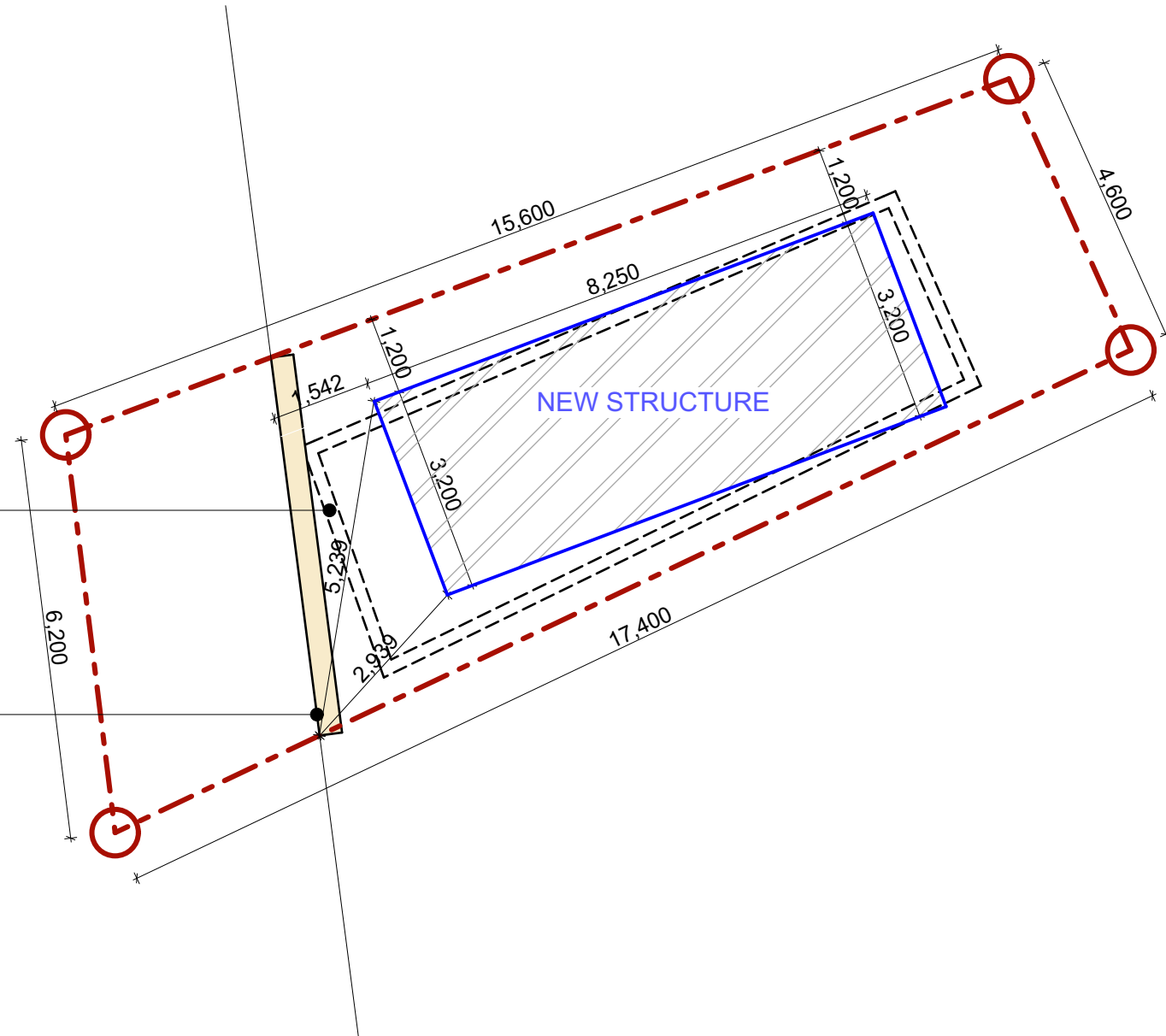

50X450 WIDE CONCRETE
COPING

400 THICK STONE MASONRY
RETAINING WALL WITH 25 DIA
PVC WEEP HOLES @ 1000 C/C

ROAD

PROPERTY SIDE

SECTION THRU' RETAINING WALL

PROJECT AFFECTED PERSON		
KAMUKAMA		
REFERENCE NUMBER		
KN-RHS-036		
	MATTERS ARISING	REMEDY
1	BLOCK OF SHOPS AFFECTED BY EXTENT OF ROAD WORKS	-CONSTRUCT NEW RETAINING WALL TO PROTECT THE STRUCTURE

DESIGN OF FACILITIES FOR 14 NO. PAPS
FOR SELECTED ROADS IN NANSANA
MUNICIPALITY

NANSANA MUNICIPAL COUNCIL
P. O BOX 7218 KAMPALA
TEL: 0782 408 022

CONSULTANT	PROJECT NO.
	SHEET NO. 10
	DATE.
	PAPER SIZE.



PROJECT AFFECTED PERSON		
MUTEBI SWALEH		
REFERENCE NUMBER		
KN-RHS-028		
	MATTERS ARISING	REMEDY
1	RESIDENCE ENCROACHED BY ROW.	-DEMOLISH EXISTING AND CONSTRUCT NEW RESIDENCE
2	BLOCK OF SHOPS ENCROACHED BY R.O.W	-DEMOLISH EXISTING & COONSTRUCT NEW BLOCK OF SHOPS

DESIGN OF FACILITIES FOR 14 NO. PAPS
FOR SELECTED ROADS IN NANSANA
MUNICIPALITY

NANSANA MUNICIPAL COUNCIL P. O BOX 7218 KAMPALA TEL: 0782 408 022	
---	--

CONSULTANT	PROJECT NO.
	SHEET NO. 11
	DATE.
	PAPER SIZE.



PROJECT AFFECTED PERSON		
MUTEBI SWALEH		
REFERENCE NUMBER		
KN-RHS-028		
	MATTERS ARISING	REMEDY
1	RESIDENCE ENCROACHED BY ROW.	-DEMOLISH EXISTING AND CONSTRUCT NEW RESIDENCE
2	BLOCK OF SHOPS ENCROACHED BY R.O.W	-DEMOLISH EXISTING & COONSTRUCT NEW BLOCK OF SHOPS

DESIGN OF FACILITIES FOR 14 NO. PAPS
FOR SELECTED ROADS IN NANSANA
MUNICIPALITY

NANSANA MUNICIPAL COUNCIL P. O BOX 7218 KAMPALA TEL: 0782 408 022	
---	--

CONSULTANT	PROJECT NO.
	SHEET NO. 12
	DATE.
	PAPER SIZE.



PROJECT AFFECTED PERSON		
SSENYONDO SILVESTER		
REFERENCE NUMBER		
NEL-LHS-002		
	MATTERS ARISING	REMEDY
1	BOUNDARY WALL AND STORE AFFECTED BY R.O.W	-DEMOLISH EXISTING BOUNDARY AND BUILD NEW ON IN LINE WITH R.O.W -CONSTRUCT 1.8 WIDE STORE IN DIFFERENCT LOCATION

DESIGN OF FACILITIES FOR 14 NO. PAPS
FOR SELECTED ROADS IN NANSANA
MUNICIPALITY

NANSANA MUNICIPAL COUNCIL P. O BOX 7218 KAMPALA TEL: 0782 408 022	
---	--

CONSULTANT	PROJECT NO.
	SHEET NO. 13
	DATE.
	PAPER SIZE.



PROJECT AFFECTED PERSON		
PLOT 4255, BLK 203, (OPPOSITE NEW ERA PRI.SCHOOL)		
REFERENCE NUMBER		
NEL-RHS-.....		
	MATTERS ARISING	REMEDY
1	BLOCK OF SHOPS (2 NO.) ENCROACHED BY R.O.W	-DEMOLISH SHOPS AND CONSTRUCT NEW BLOCK ATLEAST 1.5M AWAY FROM R.OW.
2	ROAD CONSTRUCTION LIKELY TO AFFECT FOUNDATIONS OF EXISTING SHOPS	- cONSTRUCT STONE PITCHED RETAINER

DESIGN OF FACILITIES FOR 14 NO. PAPS
FOR SELECTED ROADS IN NANSANA
MUNICIPALITY

NANSANA MUNICIPAL COUNCIL P. O BOX 7218 KAMPALA TEL: 0782 408 022	
---	--

CONSULTANT	PROJECT NO.
	SHEET NO. 14
	DATE.
	PAPER SIZE.



PROJECT AFFECTED PERSON		
NANSUBUGA MASTULA & KHALID MUKASA		
REFERENCE NUMBER		
NWK-LHS-125		
	MATTERS ARISING	REMEDY
1	BLOCK OF SHOPS (2NO.) ENCROACHED BY R.O.W	-DEMOLISH EXISTING & COONSTRUCT NEW BLOCK OF SHOPS 1.5M AWAY FROM R.O.W

DESIGN OF FACILITIES FOR 14 NO. PAPS
FOR SELECTED ROADS IN NANSANA
MUNICIPALITY

NANSANA MUNICIPAL COUNCIL P. O BOX 7218 KAMPALA TEL: 0782 408 022	
---	--

CONSULTANT	PROJECT NO.
	SHEET NO. 15
	DATE.
	PAPER SIZE.